

Ruvitex UK Ltd

# RUVITEX PVC OUTLET ROUND PARAPET L500 D110

## PRODUCT DATASHEET

### RUVITEX PVC OUTLET ROUND PARAPET L500 D110

Ruvitex PVC Outlet Round Parapet L500 D110 Ruvitex through wall outlets are intended to form a watertight seal between Ruvitex roof membranes and external roof drainage pipe work and hoppers.

The smooth internal flange provides a suitable welding area for the Ruvitex roof membrane. The flange and the membrane being welded must be clean and free from contamination prior to welding. Check seam with seam probe after welding.

The round pipe is intended to fit into a wide range of external rain water drainage pipe work. It is important that the shank of the outlet and the drainage pipe work are pushed together firmly and securely to be effective.

d1	d2	d3	L	F1	F2	F3
110mm	103mm	104mm	500mm	130mm	215mm	304mm

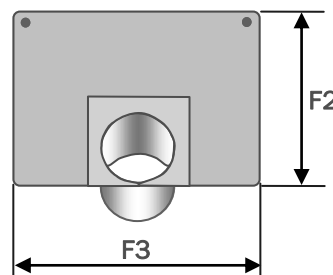
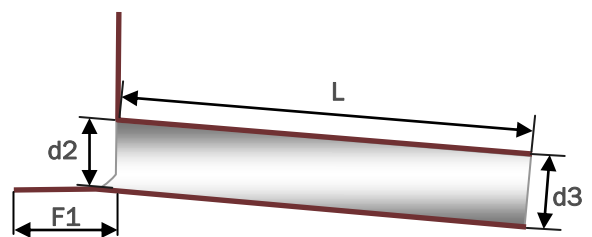
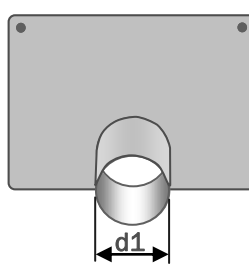

#### RUVITEX UK LTD

74 Queens Road  
Hersham  
Surrey  
KT12 5LW

Phone: +44 (0) 1484 429 397  
Mobile: +44 (0) 7939 353 595  
Fax: +44 (0) 872 115 3075  
E-mail: [info@ruvitex.co.uk](mailto:info@ruvitex.co.uk)  
Web: [www.ruvitex.co.uk](http://www.ruvitex.co.uk)

All images are for illustration purpose only and actual products may vary

RUV O RP90 REV 10 13