

PRODUCT DATASHEET



RUVITEX PVC OUTLET H240 D60

Ruvitex PVC Outlet H240 D60 Ruvitex through roof outlets are intended to form a water-tight seal between Ruvitex roof membranes and the roof drainage pipe work.

The smooth flange on the top provides a suitable welding area for the Ruvitex roof membrane. The flange and the membrane being welded must be clean and free from contamination prior to welding. Check seam with seam probe after welding.

The two rings on the shank help to form a seal between the roof outlet and the rain water drainage pipe work. It is important that the shank of the outlet and the drainage pipe work are pushed together far enough for the two rings to be effective.

DN	d1	d2	d3	d4	h
60mm	235mm	48mm	43mm	52mm	240mm

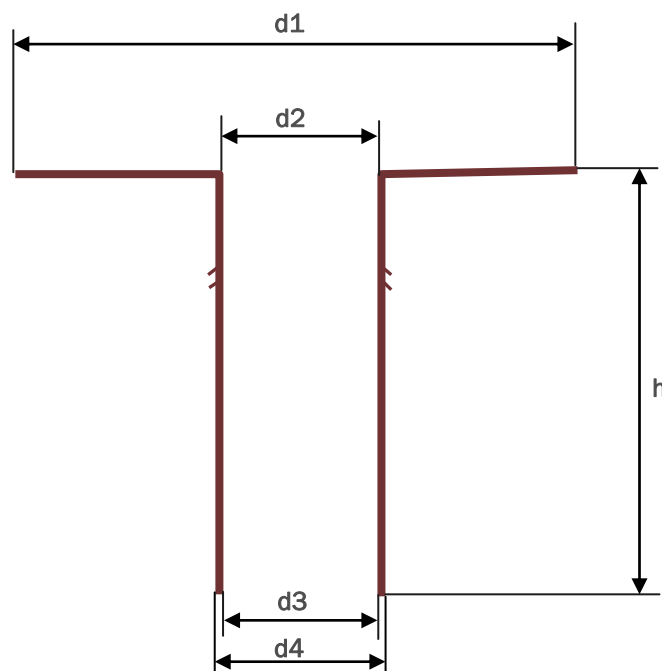

Ruvitex UK Limited
74 Queens Road, Hersham,
Surrey, KT12 5LW
T +44 (0) 1484 429 397
F: +44 (0) 872 115 3075
E: info@ruvitex.co.uk
Web: www.ruvitex.co.uk