



Ruvitex UK Limited

# Ruvitex Single Ply Roofing Systems



Call: +44 (0) 7384 589 344

Email: [info@ruvitex.co.uk](mailto:info@ruvitex.co.uk)

Visit: [www.ruvitex.co.uk](http://www.ruvitex.co.uk)

REF-CORP19



Copyright Ruvitex UK Ltd 



## RUVITEX SINGLE PLY SYSTEMS

### WHO WE ARE.....

Ruvitex UK Ltd is a specialist supplier of Ruvitex Single Ply Roofing Systems with over 40 years' experience in the UK roofing market. Ruvitex Single Ply Roofing Systems are suitable for both new construction and renovation. From fast-track projects where speed of installation is required to small intricate jobs where attention to detail and neatness is the key, Ruvitex can provide the solution.

### WHAT RUVITEX OFFER.....

Ruvitex UK Ltd provides a comprehensive range of PVC single ply roofing membranes and accessories including prefabricated edge trims, PVC coated metal sheets, restraint bars, adhesives, fasteners as well as rainwater outlets, walkways and standing seam profiles etc.

In addition, applicator training, project specifications, standard detail drawings as well as guidance on tooling, site inspection and client consultation are all part of the offer.

Whether mechanically attached, bonded or ballasted Ruvitex have a system suitable for most situations.

With over 30,000,000sqm installed, Ruvitex has a reliable track record.

Ruvitex membranes carry CE marking, BBA and comply with the latest European standard BSEN 13956.2005. Membranes have been tested by the BRE in accordance with Table 1 of BSEN 13501-5:2005 +A1: 2009 and comply with the British Fire Performance requirements and are classified as **B**roof(t4). The type, number and spacing of fasteners is determined by calculating the wind forces in accordance with the European Code, BSEN 1991-1-4. Manufactured in line with ISO 9001.

Produced in one of the most modern production lines in Europe, Ruvitex membranes are manufactured to the highest standards. Continuous monitoring of raw materials coupled with meticulous attention to detail ensures Ruvitex membranes provide many years of first class service.

### WHERE WE ARE.....

From bases in Devon, Surrey, Berkshire and West Yorkshire Ruvitex provide a fast and effective service for architects/designers, property owners and contractors across the United Kingdom.



The Systems you need







## RUVITEX BONDED SYSTEM

**RUVITEX:** Fleece backed membrane

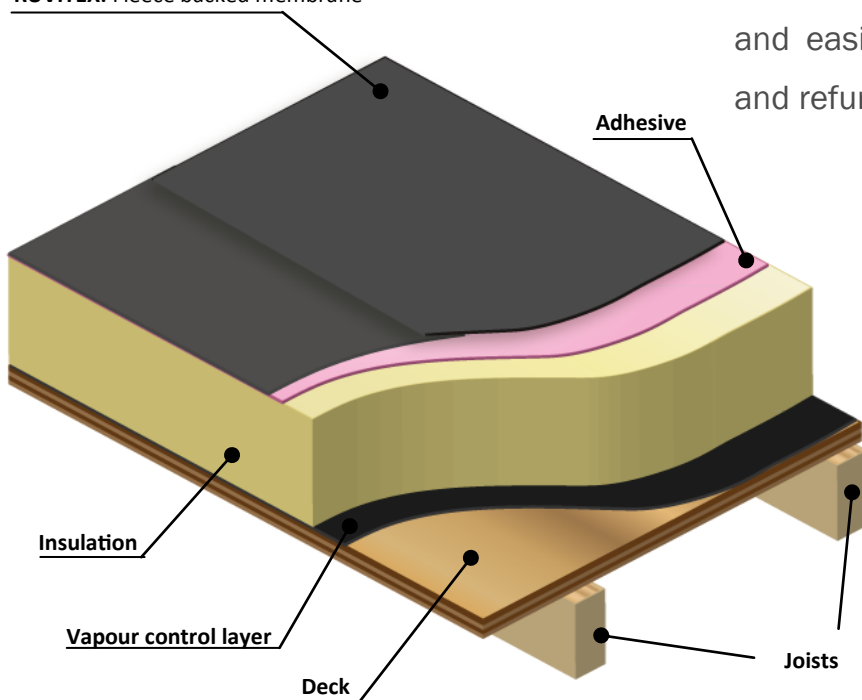

Ruvitex Bonded System is a flame free, clean and easily installed roofing system for new and refurbishment projects.

Ruviplan V membranes are manufactured with a fleece on the underside and when bonded to the substrate with Ruvitex Adhesive provide an extremely robust finish.

Ruvitex Bonded Roofing Systems are suitable for a wide range of projects, from large commercial projects to small and intricate projects.



Ruvitex Bonded Roofing Systems are extremely reliable, durable and long lasting.

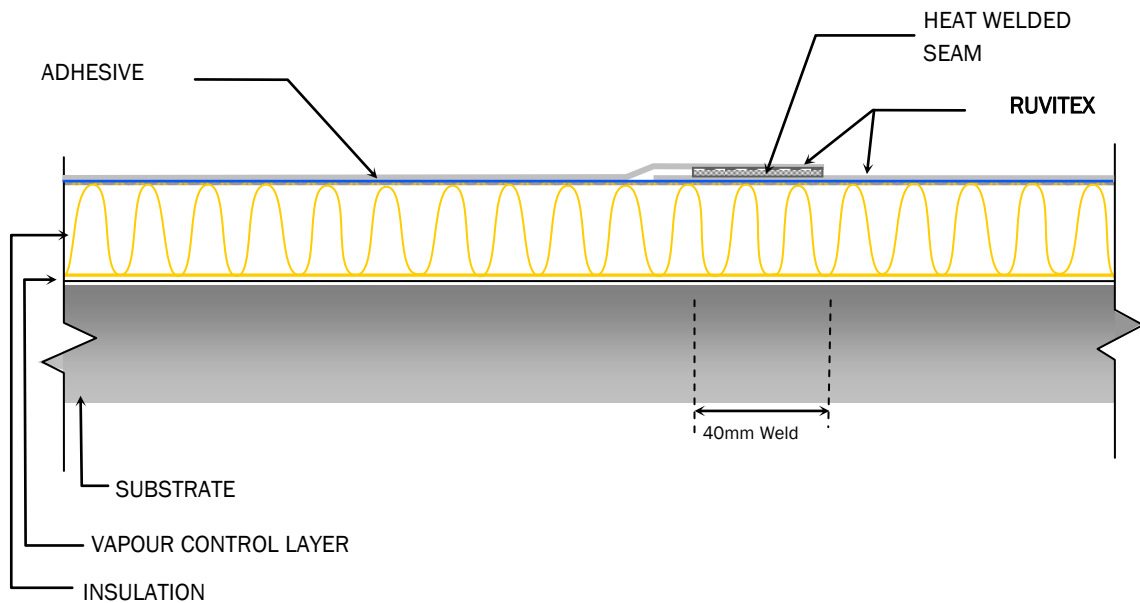

## KEY FEATURES

- Membrane over laps, detailing and jointing sealed using 'Hot Air Welding'.

- Uncomplicated installation and detailing.

- PVC coated steel trims simplify detailing at the drip, kerbs, etc.

- Moisture curing adhesives ensure a reliable and long lasting bond to the substrate.

## APPLICATION

To ensure that installation of the system is of the highest quality, Ruvitex Bonded Roofing Systems are ONLY installed by Ruvitex Authorised Contractors.





## RUVITEX MECH FIX SYSTEM

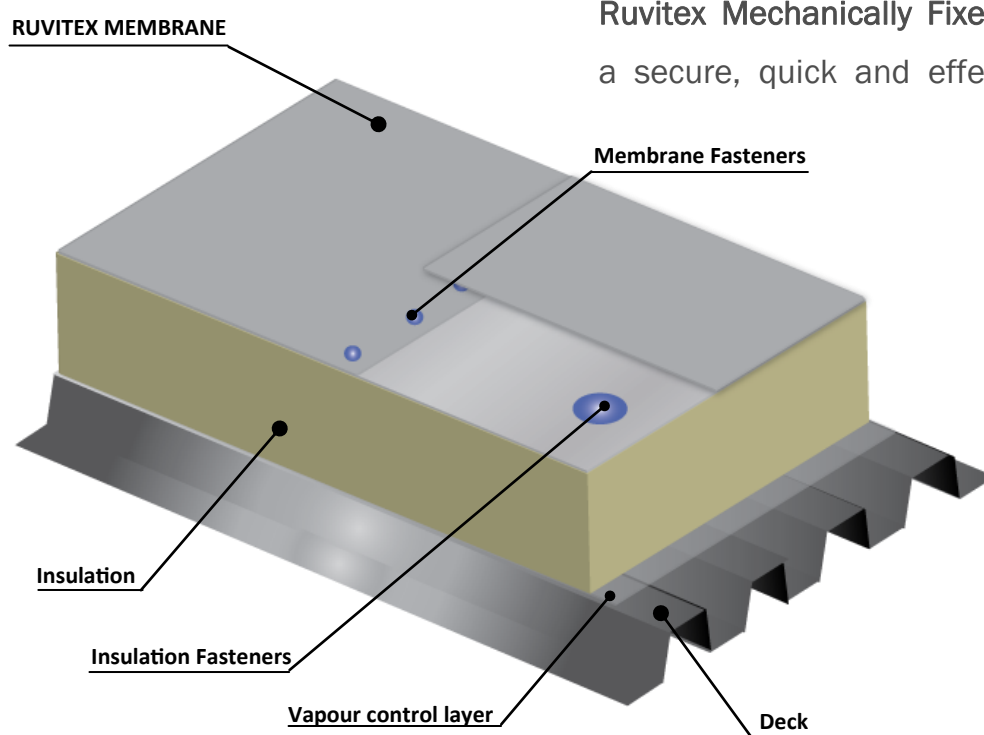

Ruvitex Mechanically Fixed Overlap System provides a secure, quick and effective solution on new and refurbishment projects.

The type and spacing between fasteners are established project by project based on calculations of wind uplift forces as recommended in EN1991-1-4:2005 + A1.2010.

Ruvitex Mechanically Fixed Overlap System can be securely fastened to most types of metal profiled decking, timber (plywood minimum thickness 18mm) and concrete decks. On all concrete and refurbishment projects a pull test by the fastener supplier is required to ensure the correct selection of fastener combination is selected.





Ruvitex Mechanically Fixed Overlap System is suitable for warm roof constructions incorporating thermal insulation as well as cold roof and renovation projects.

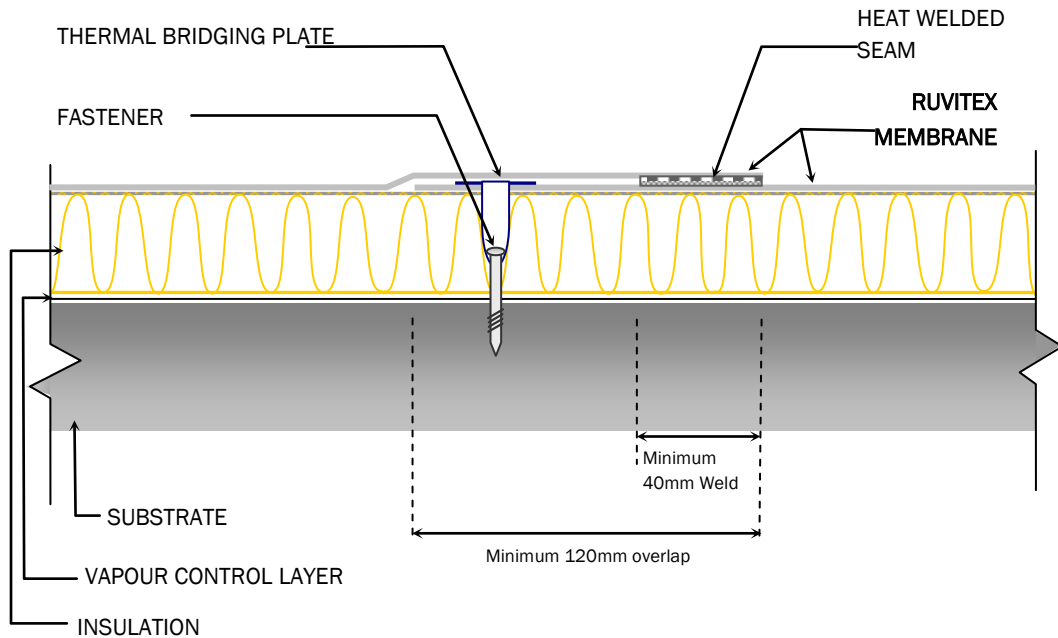

## KEY FEATURES

- Lightweight, fast and reliable system.
- Uncomplicated installation and detailing.
- Reliable track record of specification and design.

## APPLICATION

To ensure that installation of the system is of the highest quality, Ruvitex Mechanically Fixed Roofing Systems are ONLY installed by Ruvitex Authorised Contractors.

- Membrane over laps, detailing and jointing sealed using 'Hot Air Welding'.

- PVC coated steel trims simplify detailing at the drips, kerbs etc.





## RUVITEX GREEN ROOF SYSTEM

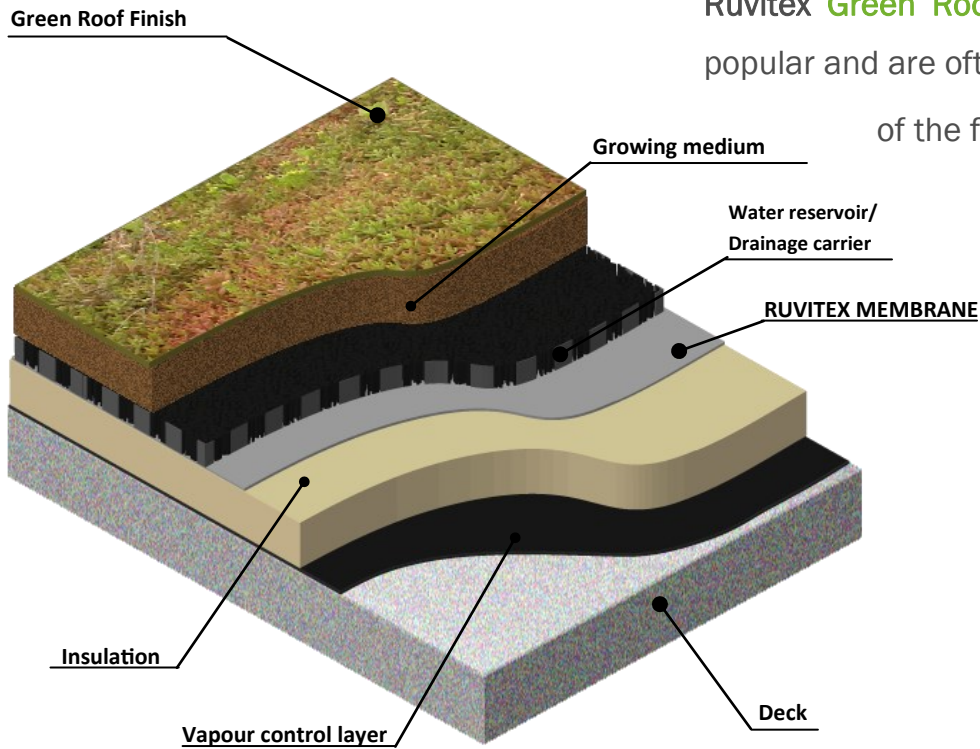

Ruvitex **Green Roof Systems** are increasingly popular and are often selected for some or all of the following benefits.

**Green Roofs** provide the ideal environment for insects, birds and spiders etc.

**Green Roofs** can positively affect the surface run off of rainfall, particularly during stormy weather.

**Green Roofs** can be used in conjunction with decking areas and provide a relaxing private area for residents.

**Green Roofs** can improve air quality due to the effect of the filtering mechanism of the plants and substrate.





Ruvitex **Green Roof** System can be constructed using a range of Ruvitex Membranes and components.

For the most effective solution contact Ruvitex Technical department at [info@ruvitex.co.uk](mailto:info@ruvitex.co.uk).

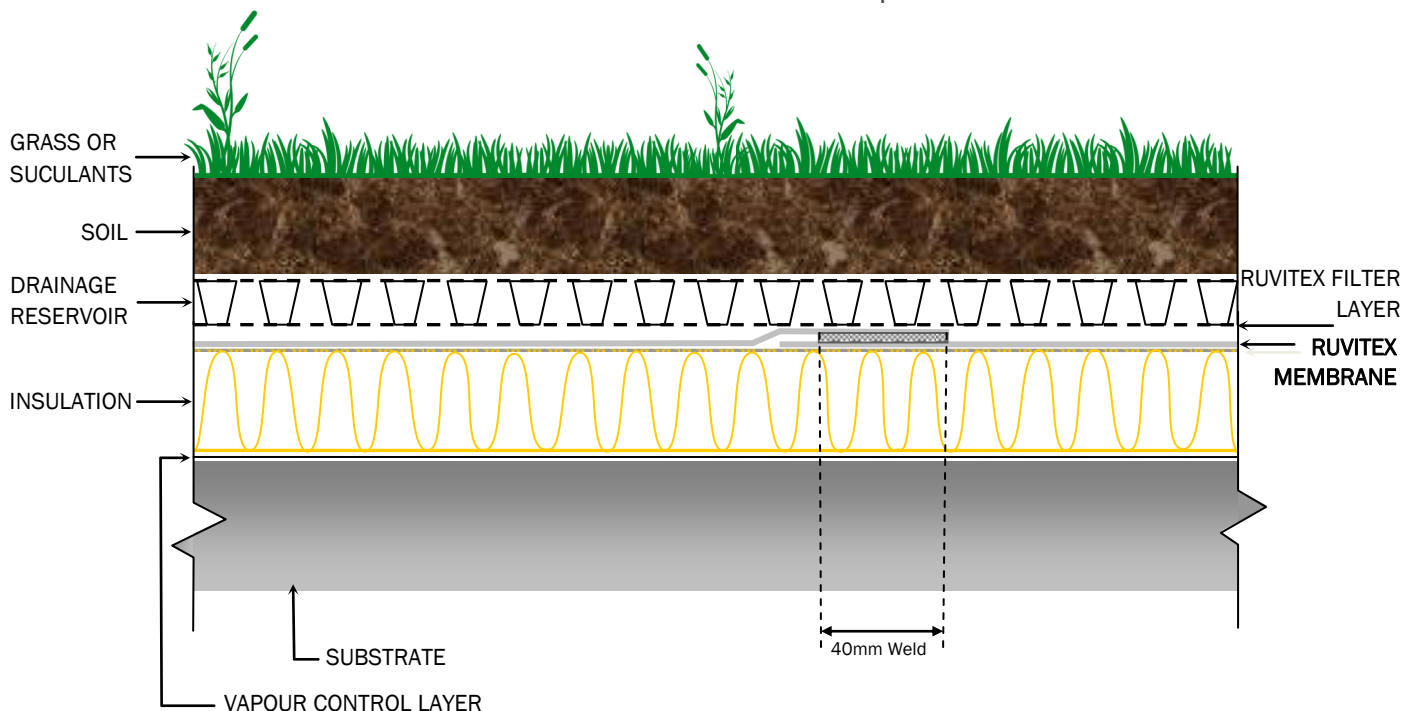

## KEY FEATURES

- Environmentally positive
- Attractive results
- Expertise on hand
- Solutions to suit

## SPECIALIST EXPERTISE

To ensure installation of the system is of the highest quality, the Ruvitex Membrane Systems are installed **ONLY** by Ruvitex Authorised Contractors and the green roof element by specialist green roof Contractors.



call: +44 (0) 7384 589 344

fax: +44 (0) 872 115 3075

# Ruvitex Accessories

Ruviplan supply a comprehensive range of accessories including:

**Adhesives** for the attachment of membranes to various substrates



**Prefabricated drip, edge and chase trims** in Ruvitex PVC coated steel

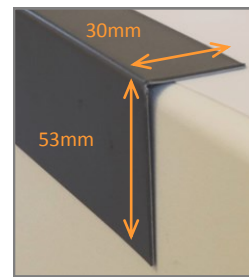
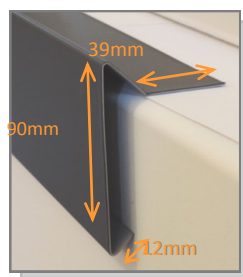
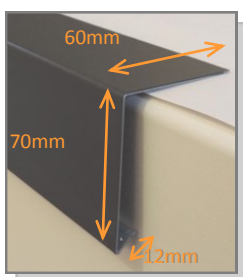

**Bespoke trims, copings and gutters** etc. in Ruvitex PVC coated steel.

Contact Ruvitex at [info@ruvitex.co.uk](mailto:info@ruvitex.co.uk) or call: **07384 589 344** for more info.

A range of **walkways** to provide safe access across a Ruvitex roof finish.

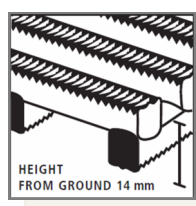



**Profiles** made from PVC intended to provide a decorative finish i.e. To simulate lead or standing seam

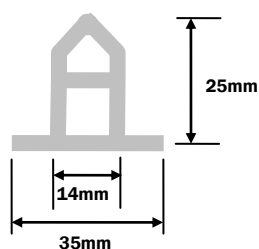

Rainwater outlets, leaf guards and roof vents etc.

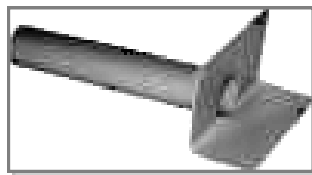

A comprehensive range of **fasteners** (screws, washers and thermal tubes)

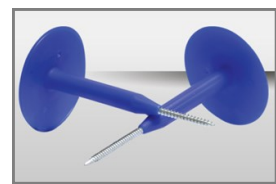
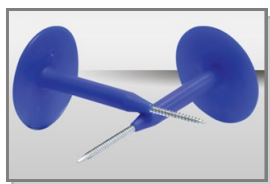

Tools and equipment suitable for the installation of heat welded PVC roofing materials







# Ruvitex Technical Support

Ruvitex provide a range of Technical Support Services to assist Contractors, Architects, Designers as well as property owners.

## Ruvitex Applicator Training

Ruvitex UK Ltd provide a range of training programmes for contractors:

### Level 1: Basic Introduction to Ruvitex Single Ply Roofing Systems.

This course is limited to the application of the Ruvitex Bonded System only and covers the skills required to set out, heat weld and form details etc as well as the scope of this system.



### Level 2: Introduction to Ruvitex Bonded System and Ruvitex Mechanically Fixed Systems.

This course covers the fundamentals of both systems including the effect of wind forces, fastening design, lap welding and a range of standard detailing.



### Level 3: A conversion course for applicators experienced in similar heat welded systems to transfer their existing skills and abilities to the application of Ruvitex Systems.



### Ruvitex Technical Consultation

Consultation is offered to ensure the most effective system build up is selected, including the type of thermal insulation.



### Prebuild Support

A range of drawings illustrating roof edge, wall junction and roof light kerbs etc

Bespoke specification documents prepared.

Review of specifications and detail drawing prepared by architects/designers.

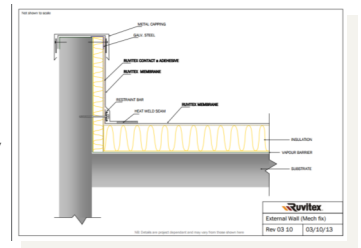

Site inspections and reports on existing roofing being considered for refurbishment.

Calculations to establish wind forces in line with BS EN 1991-1-4.

### On-site Support



A program of site inspections during the work program, designed to assist the Ruvitex Authorised Contractor and Client.

Snagging list provided where necessary.

Final sign off on completion.





Ruvitex logistics centre is located in Wokingham, Berkshire and from here products are distributed across the UK.









## Ruvitex Single Ply Roofing Systems

Email: [info@ruvitex.co.uk](mailto:info@ruvitex.co.uk)



Call: 07384 589 344



Visit: [www.ruvitex.co.uk](http://www.ruvitex.co.uk)



**Ruvitex UK Limited**  
26-28 Molesey Road,  
Hersham, Surrey, KT12 4RQ

T +44 (0) 7384 589 344  
F: +44 (0) 872 115 3075  
E: [info@ruvitex.co.uk](mailto:info@ruvitex.co.uk)  
Web: [www.ruvitex.co.uk](http://www.ruvitex.co.uk)

